

Dewi-Prys Thomas Prize 2012

Celebrating good design, and passion for good design, in the built environment in Wales

WISE Building

Pat Borer and David Lea architects



The triennial Dewi-Prys Thomas Prize is Wales's prestigious award that recognizes the importance of good design to the quality of life, identity and regeneration of Wales

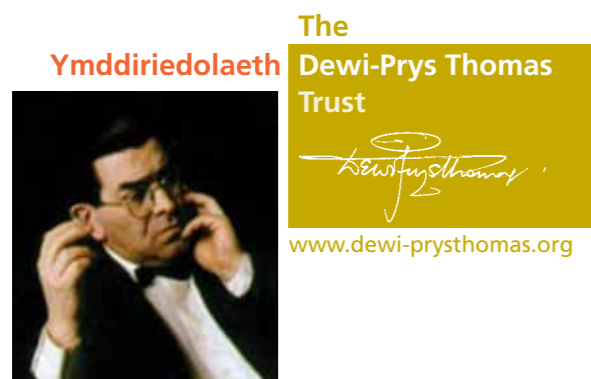

Front, 1, 2 and 3
WISE Building, Machynlleth (photographs: Tim Soar)
4
Elm Grove housing, Dinas Powys (drawing: courtesy of Graham Brooks)
5 and 6
Artificial sky and wind tunnel (photographs: CRiBE, Welsh School of Architecture)
7
Graffeg book covers (montage: Graffeg)

Winner: WISE Building, Machynlleth

The new Wales Institute for Sustainable Education (WISE) building is a substantial addition to the established complex at the Centre for Alternative Technology, Machynlleth. As would be expected of this client body and its architects, **Pat Borer** and **David Lea**, the sustainability credentials of this distinguished new building are impeccable, with low-energy materials - earth, wood, hemp and lime - being used throughout. The transparency and openness of glass technology in roof lights and windows allow the building to respond to the changing patterns and effects of daylight

and sunlight. The building acts as both a residential college of further education and a conference centre, consisting of a series of study bedrooms, classrooms, seminar rooms, teaching offices and a magnificent circular, rammed-earth walled lecture theatre. The layout is a collegiate-style series of courtyards, cloisters and verandas that step across the dramatic hillside site. As a demonstration of the issues that are taught in the institution, the rainwater system cascades, spouts and pools, and sunlight powers solar collectors and warms the naturally-ventilated working spaces.

Commendations

Graham Brooks | CRiBE | Graffeg

For over 50 years the architect **Graham Brooks** has designed distinctive, modern, Scandinavian-influenced houses in south Wales, consistently winning awards - the first being the Eisteddfod Gold Medal in 1968. While many of the homes he created were one-offs for individual clients, his greatest contribution has been in the design of small groups of houses in which he showed economic alternatives to the mediocre conventions of many private housing estates. Affordable, modern and attractively grouped, these won the affection of their inhabitants but never, unfortunately, influenced volume house builders to change their ways.

and established an international reputation in the fields of environmental design, energy efficiency of buildings and urban sustainable development through its holistic, interdisciplinary approach. Recognized as a centre of excellence by the Welsh Government, CRiBE collaborates closely with other academic groups throughout the world.

Peter Gill of **Graffeg** has published an extensive series of books on aspects of contemporary life in Wales. Each book has focused on a particular interest: landscapes, food, lifestyle, heritage, architecture, festivals, music, arts, sport and culture. They are beautifully produced, clearly written and always illustrated with wonderful photography. The books tell the story of Wales today in all its colourful variety and appeal to those who live here and to visitors alike.

Under Professor Phillip Jones, the **Centre for Research in the Built Environment** (CRiBE) at the Welsh School of Architecture, Cardiff University has pioneered research



Judges' report

The Dewi-Prys Thomas Prize may be awarded to a building and its creators, an individual, or an organisation, in recognition of a uniquely significant contribution to the quality of life in Wales through the medium of architecture.

Dewi himself made a unique contribution to the architecture of Wales, in particular to the contested idea of a self-consciously Welsh architecture. A committed modernist, yet he promoted the exploration of the nature of indigenous and appropriate design, notably in his major built work Pencadlys, Gwynedd, and significantly through his charismatic teaching at the Welsh School of Architecture.

The 2012 Prize attracted a record fifty-two nominations/entries ranging from public art, landscape and architecture projects to writing, publishing and the contributions of individuals and organisations. The short list was:

- Oriel Mostyn, Llandudno (Ellis Williams Architects)
- Graffeg
- Graham Brooks
- Roch Castle, near St Davids (Acanthus Holden Architects)
- Centre for Research in the Built Environment, Cardiff University
- WISE Building, Centre for Alternative Technology, Machynlleth (Pat Borer and David Lea architects)
- Archbishop McGrath Catholic High School, Bridgend (HLM Architects)

In commending the life's work of **Graham Brooks**, we recognize the unique contribution of an individual to contemporary housing design in Wales.

The **Centre for Research in the Built Environment** of the Welsh School of Architecture under Professor Phillip Jones is commended for its pioneering research over thirty years in low-carbon buildings and urban sustainable development.

Peter Gill's enterprising team at **Graffeg** is commended for its production of consistently colourful books about aspects of contemporary Welsh life that are accessible to all without being overly didactic.

In 2006, we commended the Centre for Alternative Technology as a pioneering laboratory of sustainability since the 1970s. This year the judges felt that the **WISE Building** was deserving of the 2012 Prize in its own right as the most complete piece of architecture built in Wales in the last three years. We celebrate the achievement of the architects, Pat Borer and David Lea, who have produced a distinguished and thoughtful building of international standard which, while complex, is deceptively simple for the user - warm, intriguing and humane with some poetic spaces. It is artful, yet in an unselfconscious way.

The Trust thanks the organisations that have supported the 2012 Dewi-Prys Thomas Prize scheme, particularly: **Tata Steel** for generously sponsoring the silver Prize Medal; **Ruthin Craft Centre** for hosting the award ceremony; and **Manorhaus**, Ruthin for its support of the winners' celebratory dinner.

Lord Dafydd Elis-Thomas PC AM
Siân Bailey
Rhys Llwyd Davies
Jonathan Vining

The Dewi-Prys 2012 is supported by:



Gwobr Dewi-Prys Thomas 2012

Dathlu cynllunio da,
a brwdfrydedd am gynllunio da,
yn yr amgylchedd adeiledig yng
Nghymru

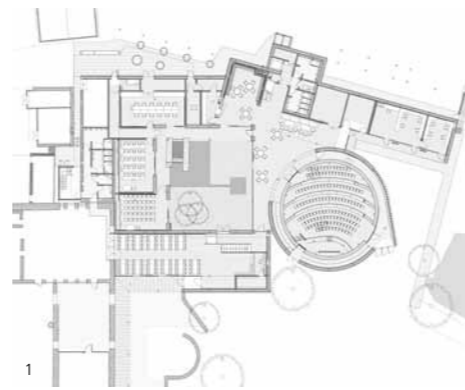

Blaen, 2 a 3
Adeilad WISE, Machynlleth (ffotograffau: Tim Soar)
1
Adeilad WISE: cynllun llawr gwaelod
(darlun: Penseiri, Pat Borer a David Lea)
4
The Mount, Dinas Powys
(ffotograff: trwy garedigrwydd Graham Brooks)
5 a 6
Twnel gwynt ac awyr artiffisial
(ffotograffau: CRiBE, Ysgol Pensaerniaeth Cymru)
7
Cloriau llyfrau Graffeg (cyfodiad: Graffeg)

Adeilad WISE

Enillydd: Adeilad WISE, Machynlleth

Adroddiad y beirniaid



Penseiri, Pat Borer a David Lea

Mae adeilad WISE (Sefydliad Cymru dros Addysg Gynaliadwy) yn ychwanegiad sylweddol i'r adeiladau sefydledig yng Nghanolfan y Dechnoleg Amgen, Machynlleth. Fel y disgwylir gan y corff hwn, a'r penseiri, **Pat Borer a David Lea**, mae cymwysterau cynaliadwyedd yr adeilad urddasol newydd hwn yn gaboledig, ynghyd â'r defnydd o ddeunyddiau ynni isel - pridd, pren, cywarch a chalc - drwyddi draw. Mae tryloywder a natur agored technoleg gwyr yn y toeau a'r ffenestri yn galluogi'r adeilad i ymateb i'r patrymau a'r effeithiau newidiol o olau dydd a heulwen. Mae'r adeilad yn

gweithredu fel coleg preswyl addysg bellach ac fel canolfan gynhadledd, yn cynnwys cyfres o loffttydd astudio, dosbarthiadau, ystafelloedd seminar, swyddfeydd addysgu a darlithfa wych ar ffurf cylch gyda muriau o bridd cywasgedig. Gosodwyd yr adeilad ar ffurf cyfres o gowrtiau fel sydd mewn colegau, cloestrau a ferandâu wedi eu gosod fel camau ar draws y llethr dramatig. I arddangos y pynciau a addysgir yn y sefydliad, mae'r system dŵr glaw yn rhoadru, tywallt a phyllu, ac mae'r heulwen yn pweru casglwyr haul ac yn ynesu'r manau gweithio sydd wedi eu hawyru'n naturiol.

Gellir dyfarnu Gwobr Dewi-Prys Thomas i adeilad a'r rhai a'i creodd, i unigolyn neu sefydliad, i gydnabod cyfraniad unigryw sylweddol i ansawdd bywyd yng Nghymru trwy gyfrwng pensaerniaeth.

Gwnaeth Dewi ei hun gyfraniad unigryw i bensaerniaeth Cymru, yn enwedig i'r syniad dadleuol o bensaerniaeth Cymreig hunanymwybodol. Roedd yn fodernydd ymroddgar ac eto, bu'n hyrwyddo archwilio cynllunio cynhenid a phriodol, a gwelwyd hyn yn ei waith mwyaf, sef Pencadlys, Gwynedd, ac hefyd, yn arwyddocaol, trwy ei addysgu carismatig yn Ysgol Pensaerniaeth Cymru.

Cymeradwyir **Canolfan Ymchwil yn yr Amgylchedd Adeiledig** yn Ysgol Pensaerniaeth Cymru dan yr Athro Phillip Jones am eu hymchwil arloesol, dros ddeng mlynedd ar hugain, i adeiladau carbon isel a datblygiad cynaliadwy trefol.

Cymeradwyir tîm mentrus Peter Gill yn **Graffeg** am iddynt, yn gyson, gyhoeddi llyfrau lliwgar ar holl agweddau bywyd cyfoes Cymreig sy'n hygyrch i bawb heb fod yn or-addysgol.

Yn 2006, cymeradwywyd Canolfan y Dechnoleg Amgen fel labordy cynaliadwyedd arloesol ers y '70au. Eleni, teimlai'r beirniaid bod yr **Adeilad WISE** yn haeddu Gwobr 2012 yn haeddiannol fel yr adeilad pensaernïol mwyaf cyflawn a adeiladwyd yng Nghymru yn y tair blynedd diwethaf. Rydym yn dathlu cyflawniad y penseiri, Pat Borer a David Lea sydd wedi cynhyrchu adeilad neilltuol a meddylgar o safon rhyngwladol sydd, tra'i fod yn gymhleth, yn dwyllodrus o syml i'r defnyddiwr - yn gynnes, yn gyfareddol a dyngarol gyda rhai manau barddonol. Mae'n gelfydd ond mewn dull anhunanyrwybodol.

Mae'r Ymddiriedolaeth yn diolch i'r sefydliadau sydd wedi cefnogi cynllun Gwobr Dewi-Prys Thomas 2012, yn enwedig: **Tata Steel** am noddi'r Wobr Arian mor hael; **Canolfan Greffttau Rhuthun** am groesawu'r seremoni wobrwyo; a **Manorhaus**, Rhuthun am gefnogi cinio dathlu'r enillwyr.

Yr Arglwydd Dafydd Elis-Thomas CP AC
Siân Bailey
Rhys Llwyd Davies
Jonathan Vining

Cymeradwyaeth

Graham Brooks | CRiBE | Graffeg

Am dros hanner can mlynedd mae'r pensaer **Graham Brooks** wedi cynllunio tai modern, neilltuol o arddull Sgandinafaidd yn ne Cymru, ac wedi ennill gwobrau yn gyson - y cyntaf oedd Medal Aur yr Eisteddfod ym 1968. Tra bo llawer o'r cartrefi wedi eu cynllunio ar gyfer cleientiaid unigol, ei gyfraniad mwyaf yw cynllunio grwpiau bach o dai ble y dangosodd dduilliau economeg amgen i gonfensiynau tila llawer o stadau tai preifat. Yn fforddiadwy, modern ac wedi eu lleoli'n ddeniadol, enillodd rhain hoffter eu trigolion ond ni lwyddwyd yn anffodus i ddylanwadu ar adeiladwyr tai sy'n adeiladu'r rhan fwyaf o stadau i newid eu ffyrdd.

da yn rhyngwladol ym meysydd cynllunio amgylcheddol, effeithlonrwydd ynni adeiladau a datblygiad cynaliadwy trefol trwy eu dulliau holistig, rhyng-ddisgyblaethol. Fe'i cydnabyddir fel canolfan rhagoriaeth gan Lywodraeth Cymru, ac mae CRiBE yn cydweithio'n agos gyda grwpiau academaidd eraill ar draws y byd.

Mae Peter Gill o **Graffeg** wedi cyhoeddi cyfres helaeth o lyfrau ar agweddau o fywyd cyfoes yng Nghymru. Mae pob llyfr yn canolbwyntio ar ddi-ddordeb arbennig: tirweddau, bywyd, ffordd o fyw, treftadaeth, pensaerniaeth, gwyliau, cerddoriaeth, y ceflyddydau, chwaraeon a diwylliant. Maent yn gyhoeddiadau hardd, wedi eu hysgrifennu'n eglur ynghyd â ffotograffau gwych. Mae'r llyfrau'n dweud hanes Cymru heddiw yn ei holl amrywiaeth ac maent yn apelio at y bobl sy'n byw yma ac ymwelwyr fel ei gilydd.

Dan yr Athro Phillip Jones, mae **Canolfan Ymchwil yn yr Amgylchedd Adeiledig** (CRiBE) yn Ysgol Pensaerniaeth Cymru, Prifysgol Caerdydd wedi bod yn arloesol wrth gynnal ymchwil ac wedi sefydlu enw

Denodd Gwobr 2012 bum deg dau o enwebiadau/ceisiadau - sy'n record - yn amrywio o gelf cyhoeddus, prosiectau tirwedd a phensaerniaeth i ysgrifennu, cyhoeddi a chyfraniadau gan unigolion a sefydliadau. Y rhestr fer oedd:

- Oriol Mostyn, Llandudno (Penseiri Ellis Williams)
- Graffeg
- Graham Brooks
- Castell Roch, ger Tyddewi (Penseiri Acanthus Holden)
- Canolfan Ymchwil yn yr Amgylchedd Adeiledig, Prifysgol Caerdydd
- Adeilad WISE, Canolfan y Dechnoleg Amgen, Machynlleth (Penseiri, Pat Borer a David Lea)
- Ysgol Uwchradd Babyddol yr Archesgob McGrath, Pen-y-Bont ar Ogwr (Penseiri HLM)

Wrth gymeradwyo gwaith **Graham Brooks** trwy gydol ei fywyd, rydym yn cydnabod cyfraniad unigryw unigolyn i gynllunio tai cyfoes yng Nghymru.

Mae gwobr deirblwydd Dewi-Prys Thomas yn wobwr sy'n cydnabod pwysigrwydd cynllunio da i ansawdd bywyd, hunaniaeth ac adfywiad Cymru

The Dewi-Prys Thomas Trust



www.dewi-prysthomas.org

Ymddiriedolaeth



Cefnogir Gwobr Dewi-Prys 2012 gan:

TATA STEEL

R Cyngor Celfyddydau Cymru Arts Council of Wales

Sir Ddinbych Denbighshire

